

HP+™ Wall System X Series

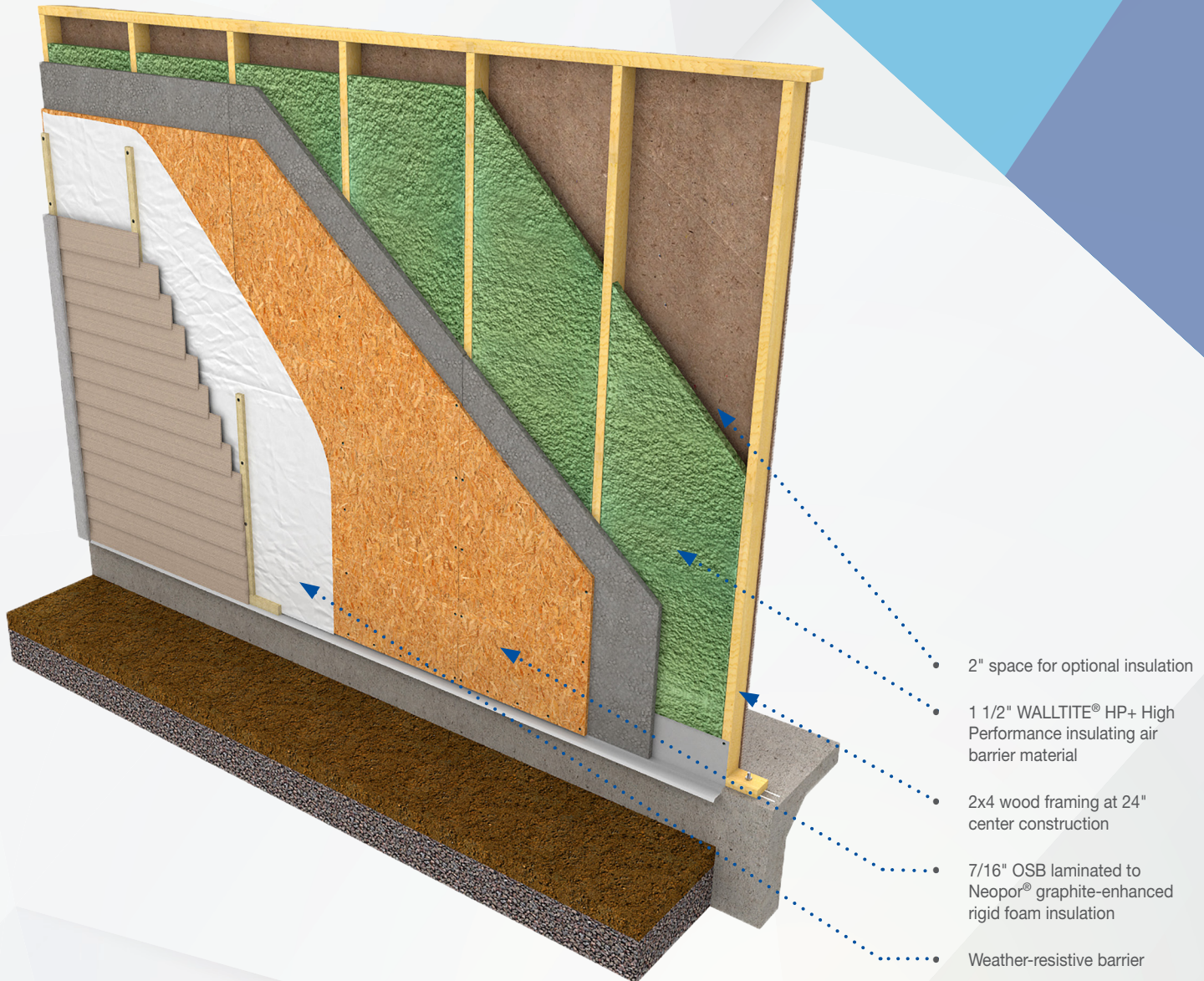

The HP+ Wall System X Series is a durable, structural assembly that offers additional durability for extreme design conditions like high wind zones and seismic zones. It meets or exceeds codes while using less wood than traditional construction, resulting in exceptional energy and cost efficiency.

Build Stronger: Create stronger, more durable structures while using less wood

Build Smarter: Create an envelope that exceeds all current energy efficiency standards

Build Sustainably: Show your commitment to the environment with a wall system that doesn't waste materials

 **BASF**
We create chemistry

Systematic Success.

The HP+™ Wall System X Series is designed to deliver a smart new way to build high performance homes affordably.

The wall assembly features the following:

- 2x4 wood framing at 24" on center construction
- 7/16" OSB laminated to Neopor® graphite-enhanced rigid thermal foam insulation available in different thicknesses and R-values to fit your climate zone needs and code requirements
- Weather-resistive barrier

From the inside of the wall:

- 1 1/2" WALLTITE® HP+ High Performance insulating air barrier material
- 2" space for optional fill insulation (fill insulation types include additional WALLTITE HP+, cellulose, fiberglass batts or blow-in-blanket system)

The HP+ Wall System X Series is just one of the offerings in our growing portfolio of HP+™ Building Enclosure Systems, which are paired with our HP+™ Consultative Solutions to complete our groundbreaking BEYOND.High Performance® approach to construction. With BEYOND.High Performance, BASF provides you with the expertise and solutions you need to meet new and changing codes and build affordable, sustainable high performance homes.

Visit us at www.basfbeyondhome.us
or call 888-307-6602 to learn more.

+ Strength in Numbers

By coupling advanced framing with foam sheathing and spray polyurethane foam in a composite design, the HP+ Wall System X Series increases structural integrity while reducing lumber content and eliminating the need for plywood or OSB sheathing. When properly designed and installed, the HP+ Wall System can offer one of the best values available for residential construction. Benefits include:

- Can reduce lumber content by up to 25%
- Stronger walls, with a design capacity up to 130% greater than a wall with typical framing and fully sheathed OSB
- Improved moisture management, which can increase thermal and structural performance and reduce builder callbacks

+ Keep The Outside Out: Thermal, Air, Moisture and Water

With integrated heat, air, moisture and vapor management in a single system, the HP+ Wall System X Series offers crucial control of outside elements.

- Provides higher thermal performance in standard dimension wall cavity, preserving your square footage
- Reduces thermal bridging with continuous insulation and fewer framing members
- Achieves optimum R-value by air sealing the wall assembly

+ Up the Efficiency. Up to Code.

With the HP+ Wall System X Series, you have a high performance assembly which improves energy efficiency while meeting stringent code requirements, all with reduced liability to you.

- Follows the Technical Evaluation Report (TER) installation guidelines, provides an effective and affordable means of improving your Home Energy Rating System (HERS) scores
- Improves moisture management, mitigating moisture-related losses
- Can reduce condensation risk
- Reduces heating and cooling loads and associated utility usage